

MILLARD
CARAVANS



2022 Range

TOURA



The trusted Name in Australia for over 70 years

Australian Made · Australian Owned · Australian Tough · For Over 70 years

From humble beginnings in a small factory located in Mortlake, NSW to today, Millard Caravans is one of Australia's most respected and highly regarded caravans with a **proven track record since 1947**. After all this time we're still one of the best caravan manufacturers in Australia, with all Millard Caravans hand-built in our Ingleburn, Sydney factory.

We pride ourselves on **value for money**. We make sure our caravans have everything you need, plus that little extra luxury that you deserve. **Quality** is at the core of everything we do. We only work with the best of the best and source the highest quality materials, finishes and appliances, just for you.

Our **customer service** is what sets us apart. We're always finding ways to put you first and help you to make the best decisions so we can build your dream caravan together. Using **cutting edge manufacturing** techniques and materials, our architecturally designed caravans are built to reflect your tastes and the lifestyle you want to live.

5 year Structural + 2 year Manufacturing warranty

All Millard Caravans are built to last with a hot dipped galvanised chassis, an Aluminium structural wall frame and full piece composite roof.

This gives you peace of mind in the longevity of the life of your quality-built Millard caravan which is backed by our commitment and promise of a 5 year Structural and 2 year Manufacturing warranty*.

Millard Caravans are accredited by RVMAP, the official accreditation key of the caravan industry. The RVMAP accreditation key is a symbol of a manufacturer's commitment to consistently build and supply quality products that adhere to all relevant Australian design rules, regulations and standards.

*Warranty period commences from the date of purchase and is effective for all new caravans built from January 2020 onwards. Terms and Conditions apply.



TOURA

The Toura range

The semi off-road Toura is Millard's latest range, designed for families and couples looking for a feature-packed van at an affordable price.

Built with our signature hot-dipped galvanised chassis, single-sheet roof, independant CRS suspension and aluminium frame, the Toura's uncompromising quality makes it the ultimate companion on your family holidays.

Select upgrades and styling options are available across our standardised couple and bunk models.



Toura 18ft

Exterior

Built with our signature hot-dipped galvanised chassis, single-sheet roof, aluminium frame and CRS suspension, the Toura has been designed for the explorer who wants to travel endless dirt roads in the Australian outback.

The Toura will take you places remote and surreal without sacrificing any comfort as the list of inclusions is endless. All Toura's are fitted with a 170w Solar Panel, External Awning, Reversing Camera, Toolbox and External speakers.

To ensure we have done everything that we possibly can to keep yourself and passengers safe in an emergency, all Millard Toura models are also fitted with Al-ko electronic stability control (ESC).

High black checkerplate and the high ground clearance from the CRS suspension ensures easy towing and protects your investment from the harsh rugged conditions during your travels.

For a full list of all standard inclusions and options please view the Specifications list in the back of this brochure. Exterior decals on all Toura models can be selected in one of four specially designed colour schemes.

Red

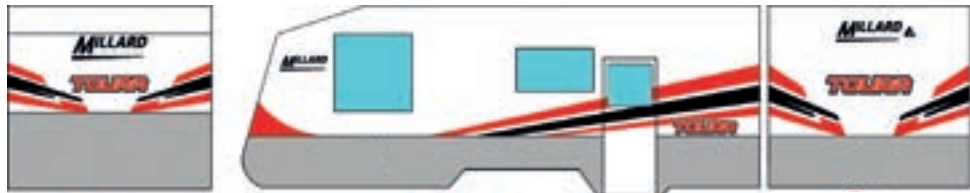

Gold

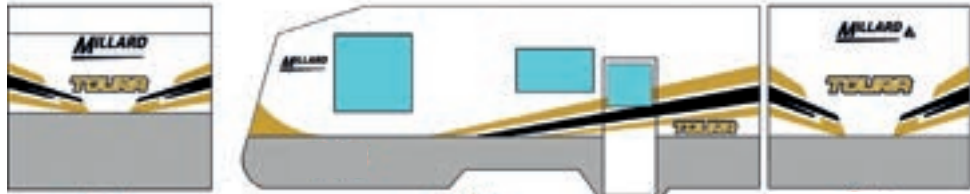

Blue

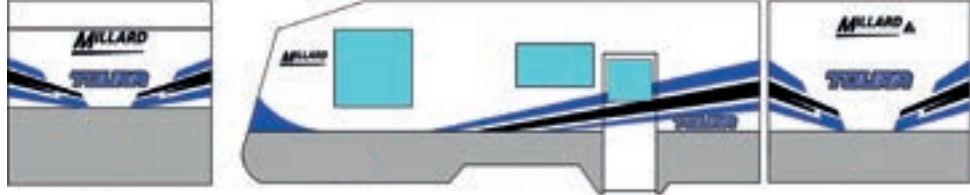

Silver

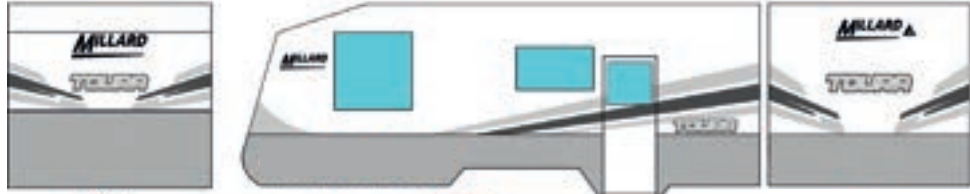

Toura 20ft 2 Double Bunk

Interior

Millard Caravans have been designed with high quality interior finishes, using the best materials to give our caravans a high end finish.

Millard pride ourselves for our unique, spacious layouts combined with large windows for abundant natural light. The Dometic high quality windows allow you to see out while also providing you with privacy also reducing sun glare and eliminate unwanted heat loss or gain.



The Toura range features Dometic Airconditioning, Dometic full oven, Front loader washing machine, TV, Radio and Speakers, Microwave and Dometic 188-224lt (model dependant) fridges.



Toura 16ft 9

Centre Door (CD) **POPTOP OPTION**

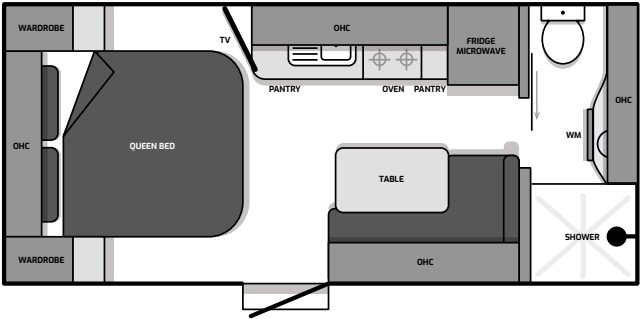

Rear Door (RD)

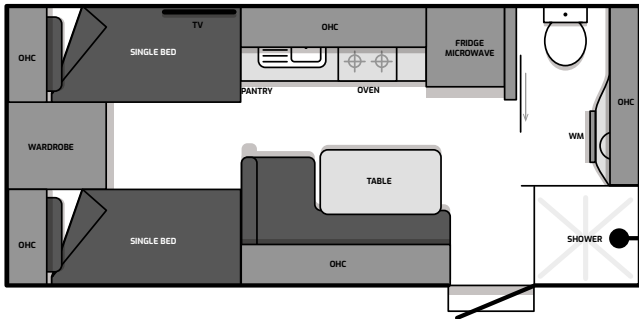

Toura 17ft 6

Centre Door (CD)

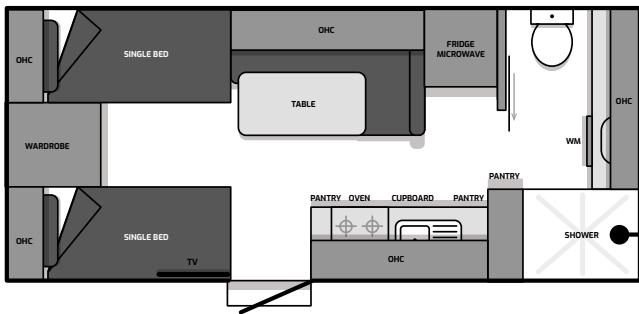
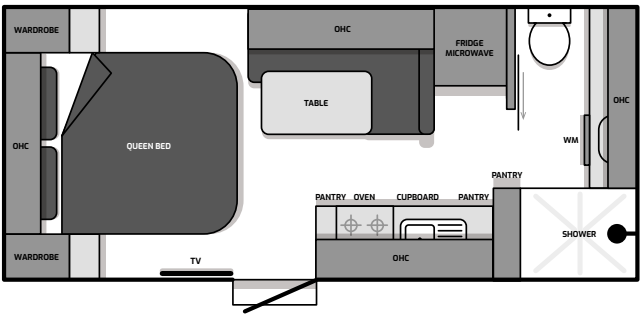

Rear Door (RD) **POPTOP OPTION**

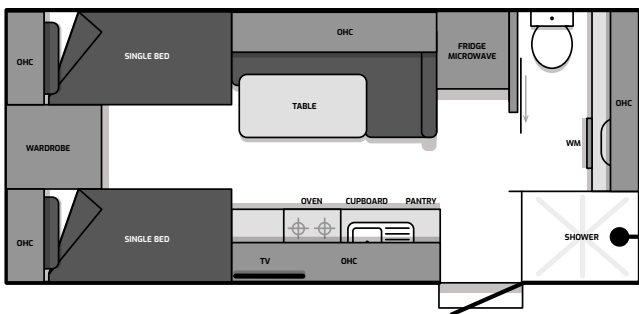
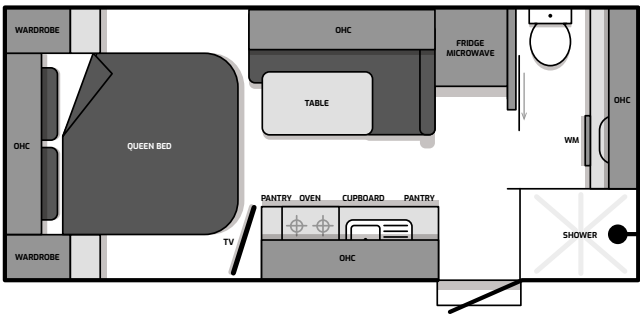

Toura 18ft 2

Centre Door (CD) **POPTOP OPTION**

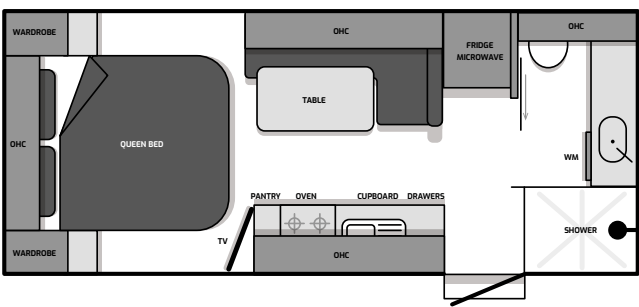

Rear Door (RD)

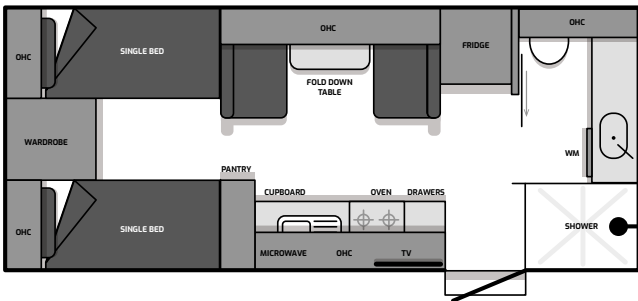
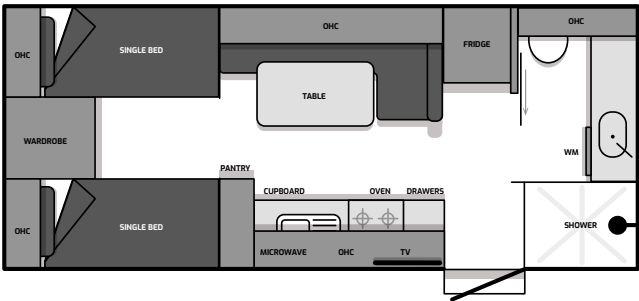

Toura 18ft 8

Centre Door (CD)



Rear Door (RD)

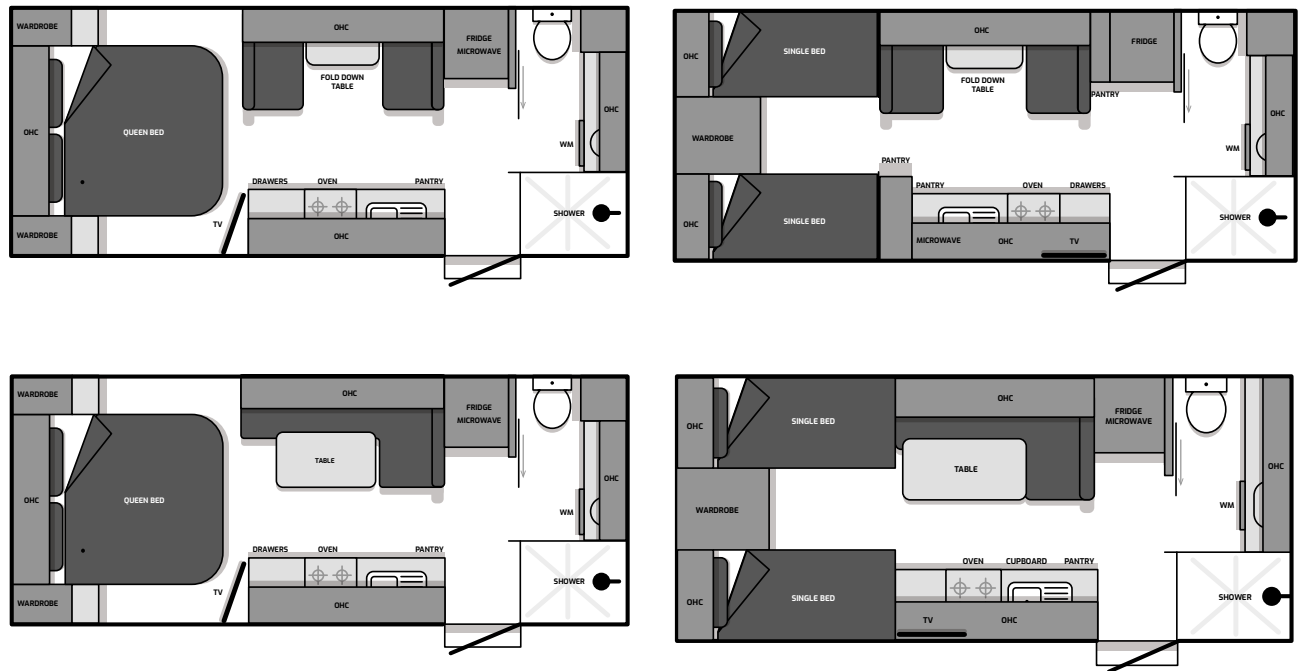

Toura 19ft 6

Centre Door (CD)

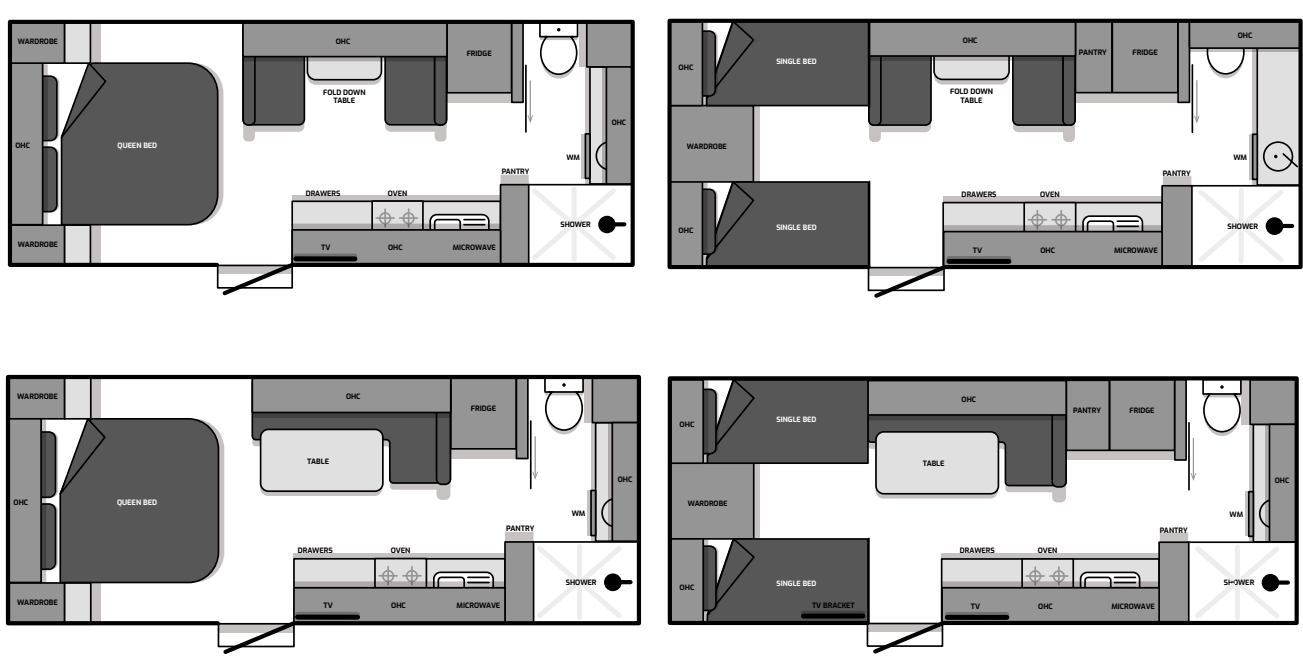

Rear Door (RD)

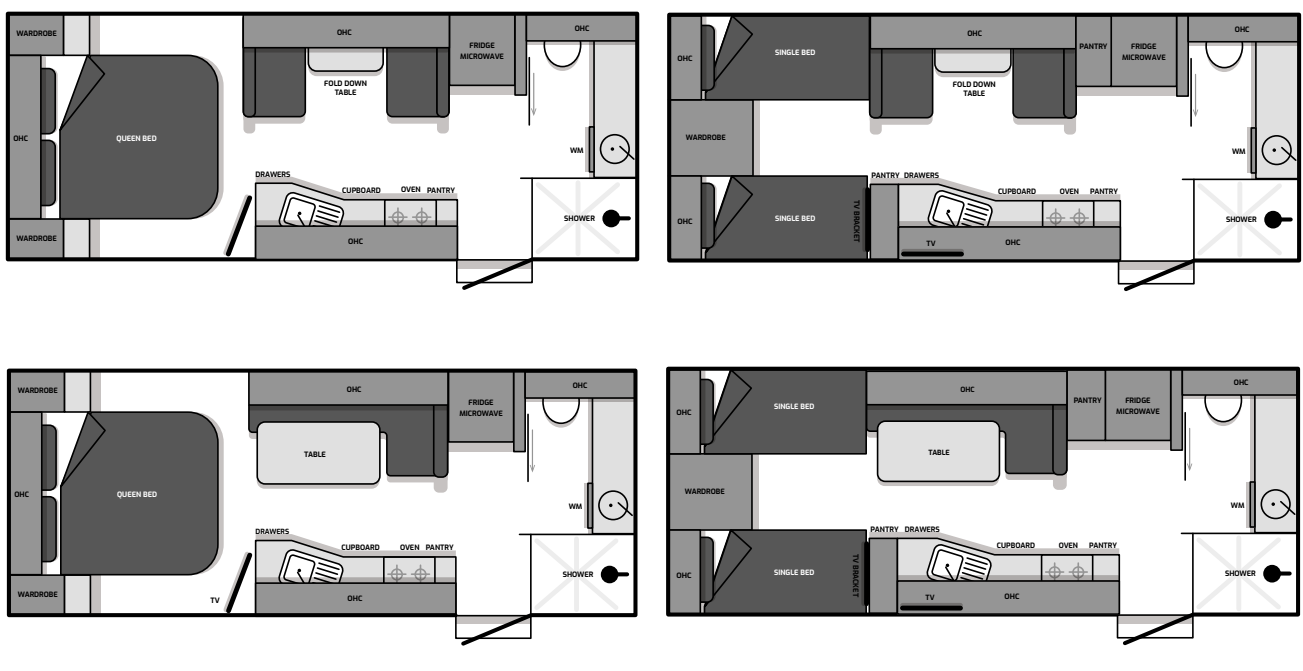

Toura 20ft 2

Centre Door (CD)

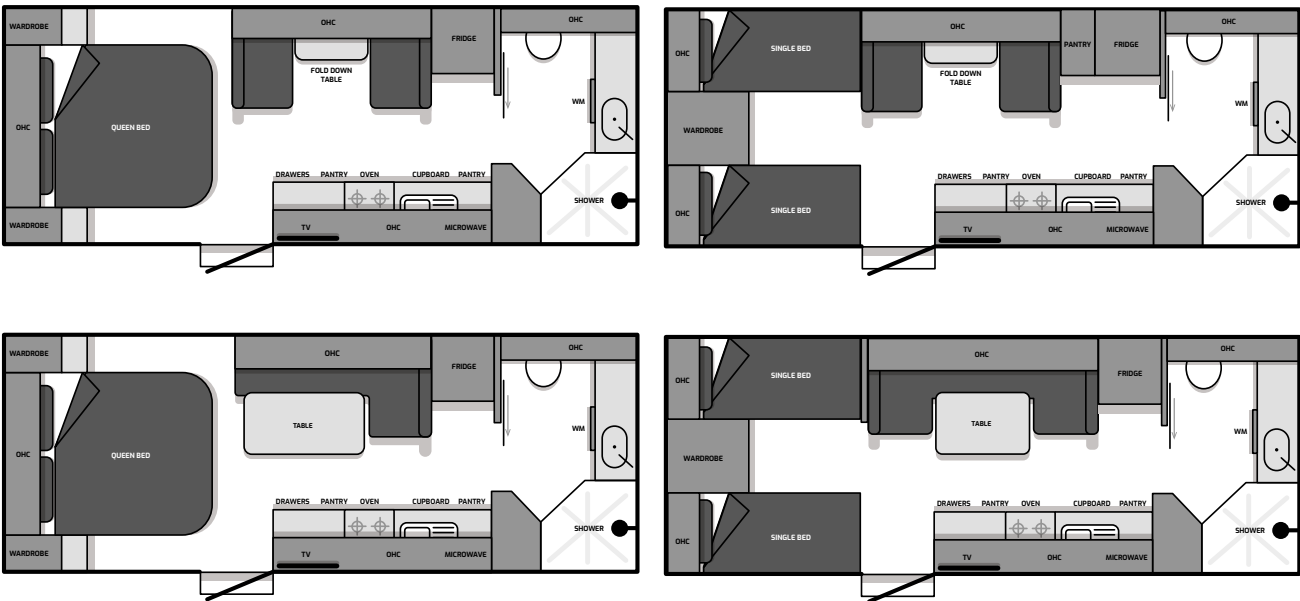

Rear Door (RD)

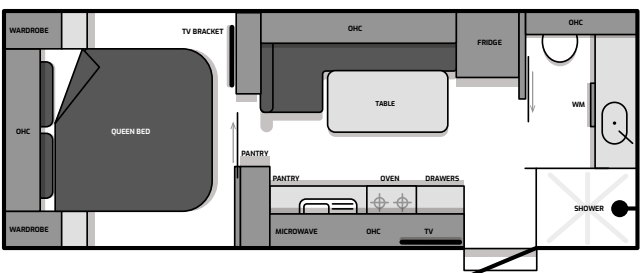

Toura 22ft 2

Centre Door (CD)

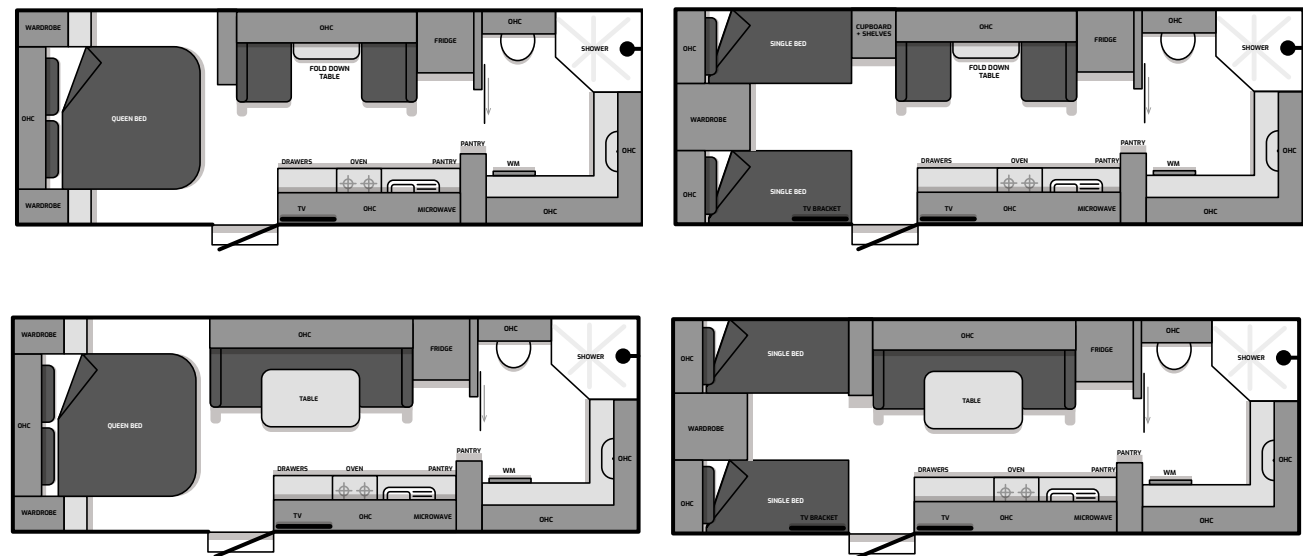

Rear Door (RD)



Toura 22ft 6

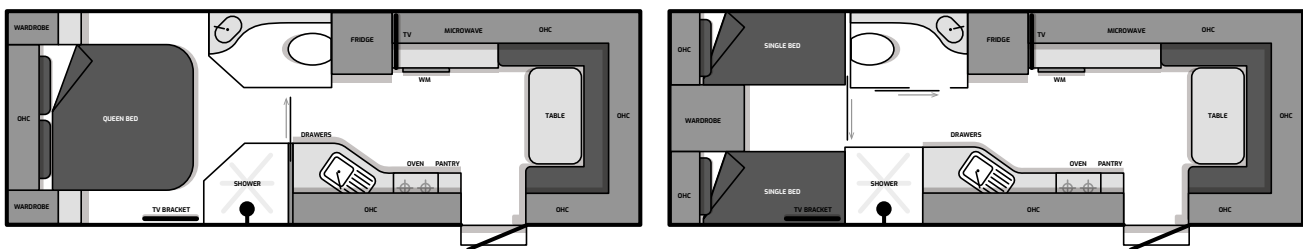

Toura Family 20ft 6

Centre Door (CD)

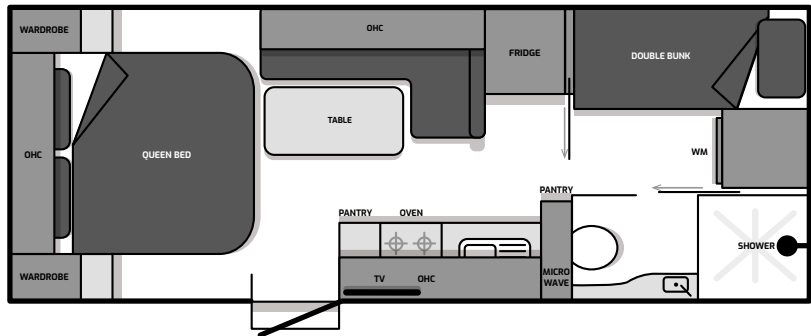

Rear Door (RD)

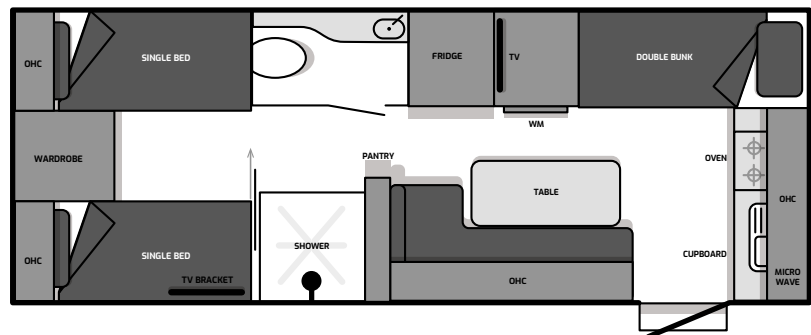
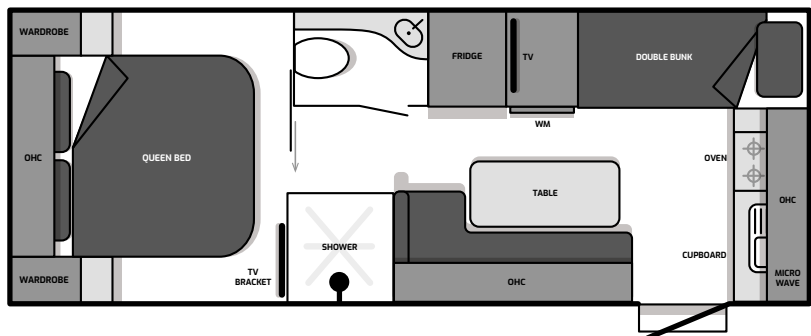

Toura Family 22ft 2

Centre Door (CD)

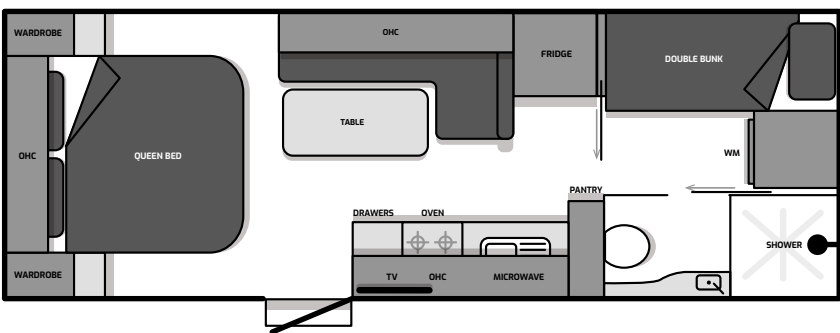

| Toura Family Vans | 20ft6" | 20ft6" | 22ft2" |
|---|-----------|-----------|-----------|
| Door Position | CD | RD | CD |
| Standard Seating | L- Lounge | L- Lounge | L- Lounge |
| Nominal Dimensions (mm) | | | |
| External length | 6412 | 6412 | 6910 |
| Internal Length | 6252 | 6252 | 6750 |
| Total Length includes A Frame & Spare Wheel | 8657 | 8657 | 9155 |
| External width (including Rollup Awning) | 2500 | 2500 | 2500 |
| Internal width | 2285 | 2285 | 2285 |
| Internal Height | 2010 | 2010 | 2010 |
| Total Travel Height with AC (Indicative) | 2975 | 2975 | 2975 |
| A - Frame to Chassis | 2015 | 2015 | 2015 |

| | | | |
|--|------|------|------|
| Weights (kgs) | | | |
| Tare Weight | 2550 | 2550 | 2760 |
| ATM (kgs) | 3500 | 3500 | 3500 |
| Carry Load or Payload (Approximate) | 950 | 950 | 740 |
| Indicative weights, subject to change as dependent on the specification and options - See note 2 | | | |
| Indicative Height, subject to the wheel size, layout and load on the van axles/suspension. | | | |

| Construction | 20ft2" | 20ft2" | 22ft2" |
|---|--------|--------|--------|
| Hot Dip Galvanised Chassis | • | • | • |
| Aluminium Wall Frame | • | • | • |
| Full Piece Composite Roof | • | • | • |
| Insulation to Walls and Ceilings | • | • | • |
| Marine Ply Flooring | • | • | • |
| Aluminium Composite Panel | • | • | • |
| Extended Draw Bar | • | • | • |
| Preset Timber Blocks (Provision for Bike Rack) | • | • | • |
| Wheel Axle | Tandem | Tandem | Tandem |
| CRS2 Cruise Master 3.5T | • | • | • |

| | | | |
|--|---|---|---|
| Exterior | | | |
| 15 inch wheels - Black with Inserts | • | • | • |
| 16inch wheels - Black with Inserts | o | o | o |
| Checker Plate - Black, approx 550mm onsides and back | • | • | • |
| Checker Plate - Silver or Charcoal | o | o | o |
| Aluminium Composite Panel - White | • | • | • |
| Aluminium Composite Panel - Silver or Charcoal | o | o | o |
| Corrugated Aluminium Cladding - White or Silver | o | o | o |
| Vinyl Decals Colours: Gold, Red, Blue, Silver,White | • | • | • |
| 2 x 95litre water Tanks | • | • | • |
| Grey Water Tank (110 Litres) | • | • | • |
| Picnic Table | • | • | • |

Key
• Standard
o Optional
- Not Available

Specifications — Family Vans

| Toura Family Vans | 20ft6" | 20ft6" | 22ft2" |
|---|--------|--------|--------|
| Mains Tap to A Frame & Mains Pressure | • | • | • |
| 2 x 9kg Gas Bottles | • | • | • |
| Double Battery Box (Single Battery 100AH) | • | • | • |
| Additional 100AH Battery | o | o | o |
| One Solar Panel with Regulator (170watts) | • | • | • |
| Additional Solar Panel (170watts) | o | o | o |
| External Awning | • | • | • |
| Annexe Lights | x2 | x2 | x2 |
| Gas Bayonet | • | • | • |
| External Speakers | • | • | • |
| External Power Point and TV Point | • | • | • |
| Entrance Door 1850mm | • | • | • |
| Tool Box with Slider | • | • | • |
| Checker Plate Wheel Arches | • | • | • |
| Reversing Camera | • | • | • |
| D035 Coupling | • | • | • |
| External Shower | o | o | o |
| External TV Point + Arm+ Locker | o | o | o |

| Internals | | | |
|---|---|----|---|
| CNC Cabinetry | • | • | • |
| Telescopic Dining Table with Tic Cushion | • | • | • |
| Exclusive Upholstery designs and Fabrics | • | • | • |
| Full Size Bedhead and Map Holder | • | • | • |
| Pelmets (Std : bedroom windows + Above seating) | • | • | • |
| Dometic Ibis 4 Air Conditioner | • | • | • |
| Dometic RUA840BX 2 Door ABSRP Fridge 3WAY 224L | • | • | • |
| Dometic RUC 840BX 2 Door Compressor Fridge 224L | o | o | o |
| Dometic MC101 Full Oven 3 Burner + 1 Gas - Grill - Oven | • | • | • |
| Dometic MC102 Cooktop 3 Burner + 1 Gas - Grill | o | o | o |
| Microwave | • | • | • |
| Slimline RangeHood | • | • | • |
| Qflow Exclusive Front Loader Washing Machine | • | • | • |
| Winegard HD Antenna | • | • | • |
| 24" LED TV | • | • | • |
| Additional 24" LED TV | o | o | o |
| Sirocco Fans | o | o | o |
| Skylight Hatch with LED lighting (7000x500mm) | • | • | • |
| Sliding Door at Ensuite | • | NA | • |
| Square mirror Frameless | • | • | • |
| 2 Bathroom Exhaust Hatches with LED | • | • | • |

| Toura Family Vans | 20ft6" | 20ft6" | 22ft2" |
|---|--------|--------|--------|
| Safety | | | |
| Breakaway Safety System | • | • | • |
| Fire Extinguisher | • | • | • |
| Smoke Alarm | • | • | • |
| Door - External 4 Pin lock with Security Screen | • | • | • |
| AL-KO ESC (Electronic Stability Control) | • | • | • |

| Fabric/Splash Board, Vanity, Kitchen Bench | | | |
|--|---|---|---|
| Number of Colour Combinations | 7 | 7 | 7 |

| Dining/Seating Configuration | | | |
|--|---|---|---|
| L- Lounge with one end foot rest and Tic Cushion | • | • | • |

| Family Bunk Van | | | |
|--|----|---|----|
| Additional Bunk | o | o | o |
| External Access Hatch 893x228mm (under 1st Bunk Bed for Double Bunks only) | o | o | o |
| Single Beds | NA | o | NA |

| Toura PopTops | 16ft9" | 17ft6" | 18ft2" |
|------------------|----------|----------|----------|
| Door Position | CD | RD | RD |
| Standard Seating | L-Lounge | L-Lounge | L-Lounge |

| Nominal Dimensions (mm) | | | |
|---|------|------|------|
| External length | 5310 | 5510 | 5710 |
| Internal Length | 5150 | 5350 | 5550 |
| Total Length includes A Frame & Spare Wheel | 7555 | 7755 | 7955 |
| External width (including Rollup Awning) | 2500 | 2500 | 2500 |
| Internal width | 2285 | 2285 | 2285 |
| Internal Height | 1620 | 1620 | 1620 |
| Total Travel Height with AC (Indicative) | 2020 | 2020 | 2020 |
| A - Frame to Chassis | 2518 | 2598 | 2598 |

| Weights (kgs) | | | |
|-------------------------------------|------|------|------|
| Tare Weight | 2100 | 2225 | 2300 |
| ATM (kgs) | 2500 | 2800 | 2800 |
| Carry Load or Payload (Approximate) | 400 | 575 | 500 |
| Ball Weight | 220 | 180 | 190 |

Indicative weights, subject to change as dependent on the specification and options - See note 2

Indicative Height, subject to the wheel size, layout and load on the van axles/suspension.

For full inclusions of PopTop range, please see corresponding model in standard specification table.

Note 1:
The tow ball and tare weights are only a guide and will change depending on accessories that are fitted to your van.
It is advisable to discuss this with your Millard Dealer covering your specific requirements.

Note 2:
Options are layout dependent and some options are not available on certain vans and should be discussed with your dealer

Specifications

| Toura | 16ft9" | 17ft6" | 18ft2" | 18ft8" | 19ft6" | 20ft2" | 22ft2" | 22ft2" | 22ft6" |
|------------------|----------|----------|----------|----------|----------|-----------------------|-----------|-----------|------------------|
| Door Position | CD | CD or RD | RD | CD or RD | CD or RD | CD or RD | CD | RD | RD |
| Standard Seating | L-Lounge | L-Lounge | L-Lounge | Dinette | Dinette | Dinette | Side Club | Side Club | Rear Club Lounge |
| Seating Options | | | | L-Lounge | L-Lounge | L-Lounge or Side Club | Dinette | Dinette | |
| Bed Options | Single | Single | Single | Single | Single | Single | Single | Single | Single |

| Nominal Dimensions (mm) | | | | | | | | | |
|---|------|------|------|------|------|------|------|------|------|
| External length | 5310 | 5510 | 5710 | 5860 | 6110 | 6310 | 6910 | 6910 | 7020 |
| Internal Length | 5150 | 5350 | 5550 | 5700 | 5950 | 6150 | 6750 | 6750 | 6860 |
| Total Length includes A Frame & Spare Wheel | 7555 | 7755 | 7955 | 8105 | 8355 | 8555 | 9155 | 9155 | 9265 |
| External width (including Rollup Awning) | 2500 | 2500 | 2500 | 2500 | 2500 | 2500 | 2500 | 2500 | 2500 |
| Internal width | 2285 | 2285 | 2285 | 2285 | 2285 | 2285 | 2285 | 2285 | 2285 |
| Internal Height | 2010 | 2010 | 2010 | 2010 | 2010 | 2010 | 2010 | 2010 | 2010 |
| Total Travel Height with AC (Indicative) | 2975 | 3040 | 3040 | 2975 | 2975 | 2975 | 2975 | 2975 | 2975 |

| Weights (kgs) | | | | | | | | | |
|-------------------------------------|------|------|------|------|------|------|------|------|------|
| Tare Weight | 2000 | 2250 | 2300 | 2390 | 2450 | 2525 | 2660 | 2660 | 2700 |
| ATM (kgs) | 2500 | 2800 | 2800 | 3300 | 3300 | 3500 | 3500 | 3500 | 3500 |
| Carry Load or Payload (Approximate) | 500 | 550 | 500 | 910 | 850 | 975 | 840 | 840 | 800 |

Indicative weights, subject to change as dependent on the specification and options - See note 2

Indicative Height, subject to the wheel size, layout and load on the van axles/suspension.

| Specification | • | Standard | o | Optional | | | | | |
|---|--------|----------|--------|----------|--------|--------|--------|--------|--------|
| Construction | 16ft9" | 17ft6" | 18ft2" | 18ft8" | 19ft6" | 20ft2" | 22ft2" | 22ft2" | 22ft6" |
| Hot Dip Galvanised Chassis | • | • | • | • | • | • | • | • | • |
| Aluminium Wall Frame | • | • | • | • | • | • | • | • | • |
| Full Piece Composite Roof | • | • | • | • | • | • | • | • | • |
| Insulation to Walls and Ceilings | • | • | • | • | • | • | • | • | • |
| Marine Ply Flooring | • | • | • | • | • | • | • | • | • |
| Aluminium Composite Panel | • | • | • | • | • | • | • | • | • |
| Extended Draw Bar | • | • | • | • | • | • | • | • | • |
| Preset Timber Blocks (Provision for Bike Rack) | • | • | • | • | • | • | • | • | • |
| Wheel Axle | Single | Single | Single | Tandem | Tandem | Tandem | Tandem | Tandem | Tandem |
| CR5 2 Cruise Master 2.5T | • | | | | | | | | |
| CR5 2 Cruise Master 3.3T | | | | • | | | | | |
| CR52 Cruise Master 3.5T | | | | o | • | • | • | • | • |
| XT Cruise Master 2.8T - Standard Arm | o | • | • | NA | NA | NA | NA | NA | NA |

| Exterior | | | | | | | | | |
|--|---|----|----|---|---|---|---|---|---|
| 15 inch wheels - Black with Inserts | • | NA | NA | • | • | • | • | • | • |
| 16inch wheels - Black with Inserts | o | • | • | o | o | o | o | o | o |
| Checker Plate - Black, approx 550mm onsides and back | • | • | • | • | • | • | • | • | • |
| Checker Plate - Silver or Charcoal | o | o | o | o | o | o | o | o | o |
| Aluminium Composite Panel - White | • | • | • | • | • | • | • | • | • |
| Aluminium Composite Panel - Silver or Charcoal | o | o | o | o | o | o | o | o | o |
| Vinyl Decals Colours: Gold, Red, Blue, Silver | o | o | o | o | o | o | o | o | o |
| 2 x 95litre water Tanks | • | • | • | • | • | • | • | • | • |
| Grey Water Tank (110 Litres) | • | • | • | • | • | • | • | • | • |

| Toura | 16ft9" | 17ft6" | 18ft2" | 18ft8" | 19ft6" | 20ft2" | 22ft2" | 22ft2" | 22ft6" |
|---|--------|--------|--------|--------|--------|--------|--------|--------|--------|
| Picnic Table | • | • | • | • | • | • | • | • | • |
| Mains Tap to A Frame & Mains Pressure | • | • | • | • | • | • | • | • | • |
| 2 x 9kg Gas Bottles | • | • | • | • | • | • | • | • | • |
| Double Battery Box (Single Battery 100AH) | • | • | • | • | • | • | • | • | • |
| Additional 100AH Battery | o | o | o | o | o | o | o | o | o |
| One Solar Panel with Regulator (170watts) | • | • | • | • | • | • | • | • | • |
| Additional Solar Panel (170watts) | o | o | o | o | o | o | o | o | o |
| External Awning | • | • | • | • | • | • | • | • | • |
| Annexe Light | • | • | • | • | • | • | • | • | • |
| Gas Bayonet | • | • | • | • | • | • | • | • | • |
| External Speakers | • | • | • | • | • | • | • | • | • |
| External Power Point and TV Point | • | • | • | • | • | • | • | • | • |
| Entrance Door 1850mm | • | • | • | • | • | • | • | • | • |
| Tool Box with Sliders | • | • | • | • | • | • | • | • | • |
| Checker Plate Wheel Arches | • | • | • | • | • | • | • | • | • |
| Reversing Camera | • | • | • | • | • | • | • | • | • |
| D035 Coupling | • | • | • | • | • | • | • | • | • |
| External Shower | o | o | o | o | o | o | o | o | o |
| External TV Point + Arm+ Locker | o | o | o | o | o | o | o | o | o |

| Internals | | | | | | | | | |
|---|----|----|----|----|----|----|----|----|----|
| CNC Cabinetry | • | • | • | • | • | • | • | • | • |
| Fold Down Dining Table | NA | NA | NA | • | • | • | • | NA | NA |
| Telescopic Dining Table with Tic Cushion | • | • | • | o | o | o | o | • | • |
| Exclusive Upholstery designs and Fabrics | • | • | • | • | • | • | • | • | • |
| Full Size Bedhead and Map Holder | • | • | • | • | • | • | • | • | • |
| Pelmets (Std : bedroom windows + Above seating) | • | • | • | • | • | • | • | • | • |
| Dometic Ibis 4 Air Conditioner | • | • | • | • | • | • | • | • | • |
| Dometic RUA6408X 2 Door ABSRP Fridge 3WAY 188L | • | • | • | • | • | NA | NA | NA | NA |
| Dometic RUA8408X 2 Door ABSRP Fridge 3WAY 224L | NA | NA | NA | NA | NA | • | • | • | • |
| Dometic RUC 6408X 2 Door Compressor Firdge 188L | o | o | o | o | o | NA | NA | NA | NA |
| Dometic RUC 8408X 2 Door Compressor Fridge 224L | NA | NA | NA | NA | NA | o | o | o | o |
| Dometic MC101 Full Oven 3 Burner + 1 Gas + Grill/Oven | • | • | • | • | • | • | • | • | • |
| Dometic MC102 Cooktop 3 Burner + 1 Gas + Grill | o | o | o | o | o | o | o | o | o |
| Microwave | • | • | • | • | • | • | • | • | • |
| Slimline Rangehood | • | • | • | • | • | • | • | • | • |
| QFLOW Exclusive Front Loader Washing Machine | • | • | • | • | • | • | • | • | • |
| Winegard HD Antenna | • | • | • | • | • | • | • | • | • |
| 24" LED TV | • | • | • | • | • | • | • | • | • |
| Additional 24" LED TV | o | o | o | o | o | o | o | o | o |
| Provisional Wiring x 2 in Bedroom for Sirocco Fans | • | • | • | • | • | • | • | • | • |
| Sirocco Fans | o | o | o | o | o | o | o | o | o |
| Skylight Hatch with LED lighting (450x400mm) | • | • | • | NA | NA | NA | NA | NA | NA |
| Skylight Hatch with LED lighting (7000x500mm) | NA | NA | NA | • | • | • | • | • | • |
| Additional Hatch in Ensuite | o | o | o | o | o | o | o | o | o |
| Sliding Door at Ensuite | • | • | • | • | • | • | • | • | • |

Specifications

| Toura | 16ft9" | 17ft6" | 18ft2" | 18ft8" | 19ft6" | 20ft2" | 22ft2" | 22ft2" | 22ft6" |
|-------------------------------------|--------|--------|--------|--------|--------|--------|--------|--------|--------|
| Ensuite - Round Mirror | NA | • | • | NA | • | • | • | RD | NA |
| Square Mirror Frameless | • | NA | NA | • | NA | NA | NA | CD | • |
| 2 Bathroom Exhaust Hatches with LED | • | • | • | • | • | • | • | • | • |
| InLine water filter at Kitchen Tap | • | • | • | • | • | • | • | • | • |

| Safety | | | | | | | | | |
|---|---|---|---|---|---|---|---|---|---|
| Breakaway Safety System | • | • | • | • | • | • | • | • | • |
| Fire Extinguisher | • | • | • | • | • | • | • | • | • |
| Smoke Alarm | • | • | • | • | • | • | • | • | • |
| Door - External 4 Pin lock with Security Screen | • | • | • | • | • | • | • | • | • |
| AL-KO ESC (Electronic Stability Control) | • | • | • | • | • | • | • | • | • |

| Fabric/Splash Board, Vanity, Kitchen Bench | | | | | | | | | |
|--|---|---|---|---|---|---|---|---|---|
| Number of Colour Combinations | 7 | 7 | 7 | 7 | 7 | 7 | 7 | 7 | 7 |

| Bed Options | | | | | | | | | |
|-------------|---|---|---|---|---|---|---|---|---|
| Single Beds | 0 | 0 | 0 | 0 | 0 | 0 | 0 | 0 | 0 |

Note 1:
The tow ball and tare weights are only a guide and will change depending on accessories that are fitted to your van.

It is advisable to discuss this with your Millard Dealer covering your specific requirements.

Note 2:
Options are layout dependent and some options are not available on certain vans and should be discussed with your dealer

Optional Extras

| Black Pack Option (Inclusions Noted) |
|--------------------------------------|
| Matt Black Kitchen Sink |
| Matt Black Round Basin |
| Matt Black Shower Rail and Head |
| Matt Black Double Towel Rack |
| Matt Black Tiolet Roll Holder |
| Black Handles |

| Internal Options |
|--|
| Additional Bunk |
| Single Beds Configuration |
| Telescopic Dining Table with Tic Cushion |
| |
| Lithium Batteries Bundle Option |
| K-RV80-03 100EL-Bundle 100Ah Elite Battery |
| K-RV80-03 125BT-Bundle 125Ah BTECH Battery |
| K-RV80-03 200BT-Bundle 200Ah BTECH Battery |
| |
| |

| Plumbing |
|---|
| Webesto AT2000 Diesel Heater with 12 litre Tank |
| Truma Vario Gas Heater |
| Dometic Slide Out Kitchen |
| Camec 240V Dryer - 3.2kgs |
| Non Return Valves at Drainage Points |
| Drink Water Filter with Gooseneck Tap |
| External Shower (Hot and Cold) |
| Eberspacher Airtronic D2 Diesel Heater |
| Truma AquaGo HWS |
| Truma Combi D6 Diesel Heater WMK Black |
| Swift 801YR Swivel Slide Out BBQ |
| Dometic MC102 Cooktop 3 Burner + 1 Gas - Grill |
| Dometic RUC 8408X 2 Door (Compressor Fridge 224L) |
| Dometic Fridge RUC6408x (Compressor 188 Litres) |
| Gas Bottles inside Toura Toolbox |

| External Options |
|---|
| Bike Rack |
| Stone Guard Protector |
| Jerry Can Holders |
| Aluminium Corrugated Cladding (Whiteor Silver) |
| Pressure Hatch / Scupper Vent |
| Mesh on the A- Frame |
| Dometic Dust Hatch |
| Carafan CP700 Pressuriser |
| Wheel Upgrade to 16" |
| Front Window with Cover |
| 893x228mm Access Hatch (under 1st Bunk Bed for Double Bunks only) |
| Additional Skylight Hatch with LED Lighting (Ensuite) |
| Underslung Wheel Carrier |
| Additional Spare wheel + Bracket +T bar for No. Plate |
| Double or Single Electric Step |
| Manual Double Step |
| Heavy Duty Bumper |
| Additional Awning Support Bracket |

| Electrical |
|--|
| Additional Solar Panel and Regulator 170 watts |
| 12V Sirrocco Fans |
| Additional 12V Power Point Outlet |
| Additional External Power Point |
| External TV Point + Arm + Locker |
| Additional Internal Double Power Point |
| Extra Annexe Light |
| Additional Battery |
| Additional Internal TV Point +TV+Bracket |
| External Bar Light |
| Anderson Plug |
| Sphere Satellite System |
| Additional LED Downlights |
| BM Pro Charging and Monitoring System |
| Additional Internal TV Point |



Geelong Caravans & RV Centre
(03) 5248 2666
info@geelongcaravans.com.au
geelongcaravans.com.au

Your ticket to *freedom*

YOUR VICTORIAN AUTHORISED MILLARD DEALER:

Geelong Caravans & RV Centre

03 5248 2666

134-136 Bellarine Hwy
Newcomb (Geelong), VIC 3219

info@geelongcaravans.com.au



geelongcaravans.com.au

03 5248 2666